



KNOWING<sup>†</sup> GROWING<sup>†</sup> SERVING<sup>†</sup>

# Christ's Way | Zion's Ministry Expansion Campaign



## From Your Impact Phase Director...

### What a wonderful start to our *Christ's Way* Capital Campaign!

God's blessings to all of you! We are now in month three of the Christ's Way Capital Campaign and as you can see, we are well on our way! Be on the lookout for a display hanging up in the narthex area showing our progress. The school kids helped by adding their own personal touch to the display! The impact phase team has been working on a calendar of events, as well as working with the building committee on a potential timeline for Phase One. Thank you all so much for your generous giving toward the Christ's Way Campaign and the potential "new ministry" it will offer our community. Don't forget our current ministry is always in need of your time, talents, and treasures. Please realize that before we can move forward with future plans, we have to rectify our current financial situation. God is in control; trust Him to show us the way!

**Christ's Way**  
Impact Phase Director,  
Kevin Aker

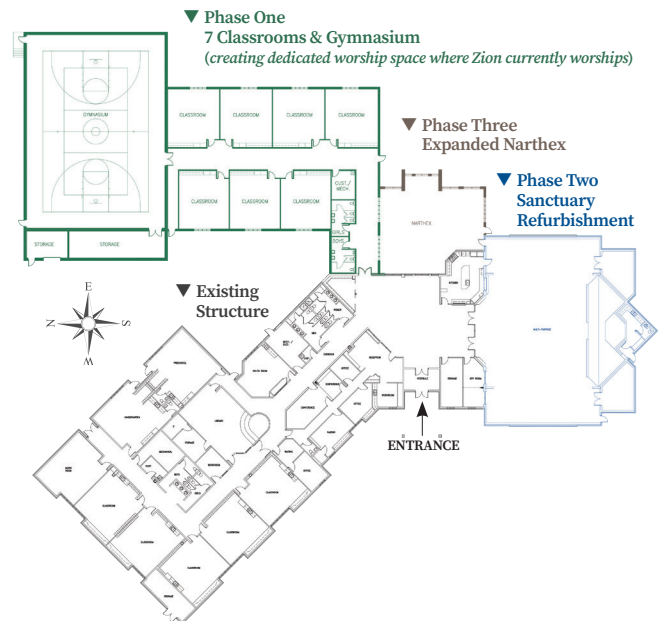

*For we walk by faith, not by sight. ~ 2 CORINTHIANS 5:7*

# For We Live By Faith, Not By Sight

## *A Story of Stewardship by Hope Rose*

When I met my husband, Nathan, I felt my prayers had been answered. He had three sons, and our family was complete. But one day, I felt a strong urge to grow our family. I shared my feelings with Nathan. He was unsure if this was our path to take. I prayed for peace and decided to give these feelings to God.

A few months passed. Then one day, Nathan told me he had thought long and hard about what I had said. And he agreed: it was time for us to grow our family. We started our adoption process.

First we met with an international adoption agency. We encountered road blocks with every single country's adoption guidelines. We were frustrated and discouraged. But now, looking back, we know that God was leading us to our daughter.

During this time we leaned on our church family. We sought support and advice from Jon and Lynette Epp, who themselves had walked the adoption road not long before. We eventually found a domestic adoption agency. For three years, we prayed. At times, we felt that an adoption might not happen. But we never lost faith. We trusted that the right child would come to us. Our church family supported us in prayer and presence, encouraging us in our faith.

## *A Message from Your Campaign Chairs*

### **Sacrificial Giving: Meeting the need, then going beyond**

We are starting the third month of the *Christ's Way* Campaign, and we are hitting it out of the park! We have already received well over \$200,000 of the \$1.5 million pledged. We love to report this kind of news!

At the same time, our general fund has taken a hit on regular giving. This news is hard to share but it is necessary. The church and school still must be able to pay its bills ("keep the lights on") and pay its staff (including teachers, janitors, administrative assistant, DCE and pastor).

This is the time for sacrificial giving. What does that mean? It means pushing outside of your comfort zone and asking what you might be willing to give up (sacrifice) in order to see our collective vision come to fruition. It might mean giving up one dinner out per month for the next year and putting the \$50 you would have spent on that dinner into the offering plate. It might mean less frequent trips through the coffee drive-through, or waiting just a little while longer before you trade in a reliable vehicle for newer, shinier wheels. It means seeking *Christ's Way* through prayer to help us expand HIS ministry, using the resources that are His to begin with.

If we are going to realize our vision to build a new gym and seven new classrooms, refurbish our current sanctuary and expand the narthex, it is going to take all of us. And, it is going to take all of us giving beyond the status quo, thinking outside the box, trusting the Lord to meet our needs as we return to Him the fruits of our labor.

First and foremost, our church and school needs your regular giving to the general fund, to sustain the ministry and operations we already have. IF you are able and willing to give beyond that tithe, only then would we ask for your help in supporting the Capital Campaign.

The mission before us is not easy. But we are a family with big goals, a family that sees the incredible potential of our church, school and preschool on the hill. We have a tremendous opportunity to serve our neighbors as more and more families seek educational options and a loving place to belong.

How will we respond? We invite you to pray with us:

Jesus,

**Will you guide us and bless us and show us, your children, how to pray for Zion Lutheran Church, School and Preschool? Help us to be a blessing to our Zion family as well as to our community. Bless our staff in their tireless ministry and help us to provide and care for them. Grow Your footprint here, if it is Your will, and help us to fully trust you. We ask all this in Jesus's name.**

Amen.

*Christ's Way* Co-Chairs, Don Valenti & Bill Aker

---

**First and foremost,  
our church and school  
needs your regular  
giving to the general  
fund, to sustain the  
ministry and operations  
we already have.**

Our church family supported us in prayer and presence, encouraging us in our faith.

Our daughter's birth mom chose us because she knew we wanted a baby girl. Our long wait was not in vain; it was literally God matching us to the right child. Our daughter truly is a walking testament of three years' worth of answered prayers! And those prayers, we know, were not just ours; they were prayers of a church family who came around us during a time when faith was all that mattered. Our faith led us to trust God that our daughter would one day be ours forever. The support of our church family led us to fully trust God and His timing.



## *We Look to the Lord in Prayer* by the Christ's Way Prayer Team

*Rejoice in the Lord always; again, I will say, rejoice! Let your reasonableness be known to everyone. The Lord is at hand; do not be anxious about anything, but in everything by prayer and supplication with thanksgiving let your requests be made known to God. And the peace of God, which surpasses all understanding, will guard your hearts and your minds in Christ Jesus. ~ PHILIPPIANS 4:4-7*

It's an exciting time for our church, school and preschool! We have already accomplished a lot toward Zion's Capital Campaign. Indeed, God is at work—through us, and through you.

Please join in praying a prayer of thanksgiving and asking for God's continued blessings and guidance:

Dear Lord God,

Thank you for all the blessings you have given us at Zion in the past and now give during this Capital Campaign. We praise you for this Christian Family of Zion! Please help us to grow spiritually, that we will be drawn closer to You and closer to one another throughout this time of sacrificial giving.

We are excited for the planned growth of Your church! We pray that Zion Lutheran Church, School and Preschool would be a way for many families to grow in Christ's love.

We thank you for working through our hearts in the pledges received thus far. Please continue to guide us in our giving, as we care for and lift up one another. May our gifts be above what we normally give in our offering, so that our ministry in Rapid City might reflect Your love in exponential ways.

Help us to serve in Zion's ongoing ministry activities, even as we look to the future through this Capital Campaign. Help us to use our unique gifts to further Zion's mission of Knowing Jesus, Growing in Faith, Serving with Love.

We pray in Jesus's name,

Amen!



KNOWING<sup>+</sup>GROWING<sup>+</sup>SERVING<sup>+</sup>  
**Christ's Way** | Zion's Ministry  
Expansion Campaign  
4550 Mt Rushmore Rd  
Rapid City, SD 57701

Visit our  
*Christ's Way*  
web page:  
[www.zionrc.org/  
Christ'sWay](http://www.zionrc.org/Christ'sWay)

Pick up a  
**Frequently-  
Asked-Questions  
(FAQ) document**  
or submit a Question  
Submission form  
in the narthex

**Prayer  
Request  
forms**  
are available  
in the narthex



***Campaign gifts may be placed  
in the Christ's Way box in the  
narthex. Envelopes available.***

**“Now to Him who is able to  
do immeasurably more than  
we can ask or imagine...”**

**~ EPHESIANS 3:20-21**